

# Dunbar Area Early Years Profile



## Introduction

Support from the Start is a network of people and organisations who are working for the 'Best Possible Start for All Children in East Lothian. The network uses local knowledge and the information in this profile to work towards the following outcomes for children:-

- Have positive parenting & experience good attachments at an early stage
- Are ready to learn and achieve
- Can access quality child care experiences
- Are healthy & happy
- Are not living in poverty
- Have a good opportunity for play
- Are protected from harm

The Dunbar Area Support from the Start group was launched in August 2012. Its 'core group' has met on a regular basis since then led by Linden Ross previously a teacher and voluntary sector charity manager. The groups key achievements so far include:-

- Supporting the development of a support group for young mums
- Supporting the development of Baby massage in the area

- Support the provision of the Raising Children with Confidence course for Dunbar parents
- Improving links between services and practitioners' for early years

### Dunbar Cluster Area Overview

Dunbar and its surrounding areas are situated at the eastern end of East Lothian. It includes the settlements and areas of Dunbar, East Linton, West Barnes, Stenton and Innerwick. The area has one secondary school and five primary schools with attached nursery classes. It has a population of some 13,000 ([www.sns.gov.uk](http://www.sns.gov.uk)). This is a little more than 13% of the population of East Lothian as a whole.

### Population

Across East Lothian the population is growing, with a growth rate of 7% since 2001. However the growth rate in Dunbar over the same period is double and stands at 15%. The population is expected to continue to increase over the next few years as a result of new house building and other factors. This is illustrated in the projected school roll figures for East Lothian (Fig 1).

Figure 1 - Projected School Rolls 2012 to 2022<sup>1</sup>

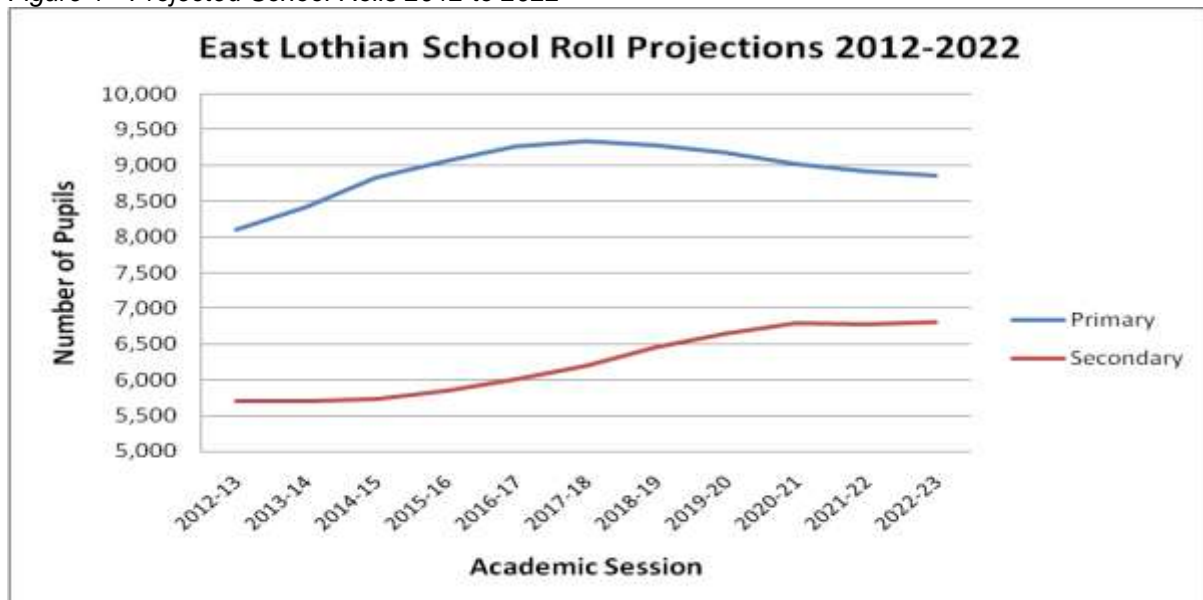

The age distribution of Dunbar is broadly similar to East Lothian. However there are slightly more children and fewer people of working age than across East Lothian as a whole (Table 1)

Table 1 - Population age composition<sup>2</sup>

Population Percentage	Dunbar Cluster	East Lothian
Children & young people (0-15)	21%	19%
Working age (16-64)	58%	60%
Pensionable age (65+)	21%	21%

<sup>1</sup> East Lothian Council Education Department

<sup>2</sup> [www.sns.gov.uk](http://www.sns.gov.uk)

## Health

Health indices in general are highly positive across the cluster area. For example the entire Dunbar cluster area has higher breastfeeding rates and lower rates of smoking in pregnancy than the rest of East Lothian (Fig 2).

Figure 2 - Breastfeeding and maternal smoking in pregnancy<sup>3</sup>

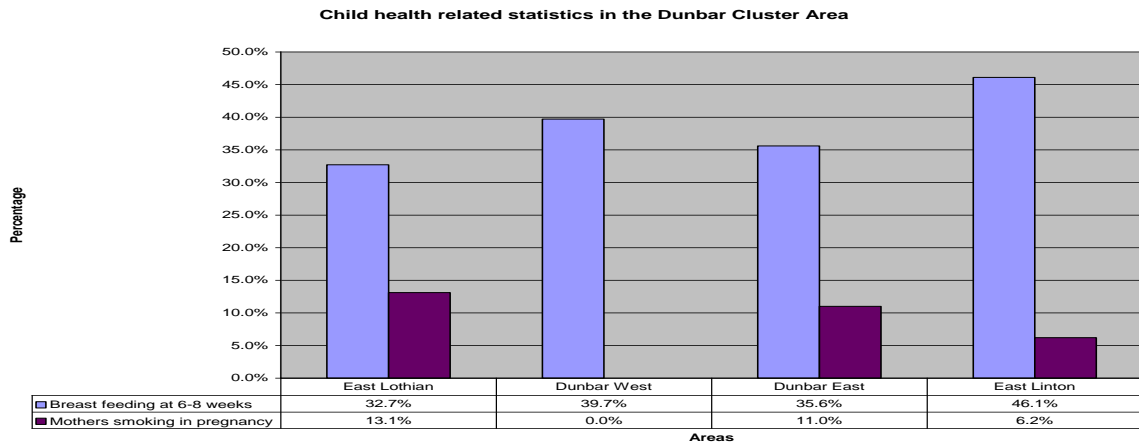

## Education

In primary one the standard assessment used to measure the abilities of new pupils in reading, writing and arithmetic are, for the most part, consistently higher over time than the national average of 50% (Fig. 3).

Figure 3 - Average standardised PIPS scores at P1 baseline assessment<sup>4</sup>

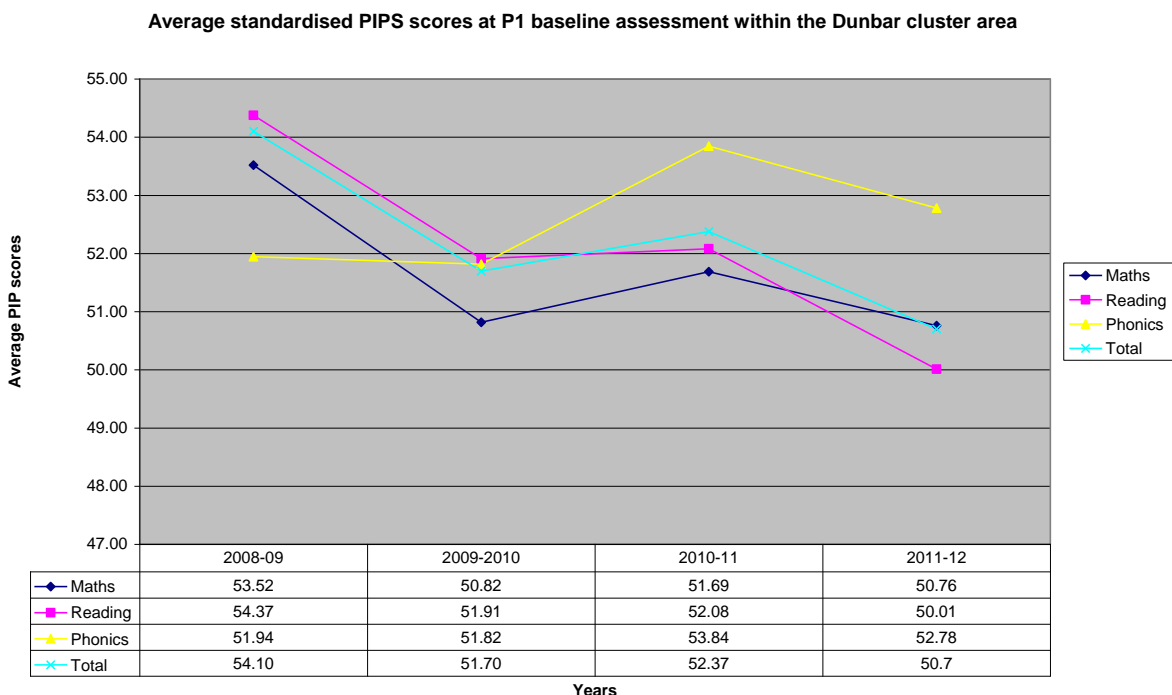

<sup>3</sup> East Lothian Health & Wellbeing Profile 2010 ([Scottish Public Health Observatory](#))

<sup>4</sup> East Lothian Council Education Department

## Early Development Instrument <sup>5</sup>

Across all socioeconomic status groups, East Lothian 5 yr olds: do quite well in physical health and well-being and cognitive/language development domains; score average in social competency; and score less well in emotional maturity and communications and general knowledge domains.

Within the Dunbar cluster the overall range of scores of children was very similar to East Lothian as a whole (Fig 4) and compared quite well with all of the other cluster areas (Appendix 1). Dunbar has an almost identical pattern of scores to East Lothian as a whole in all domains. It has a middle ranked percentage of children in scoring low on at least one domain (Appendix 2).

Figure 4 - EDI mean scores for domains in Dunbar cluster and East Lothian

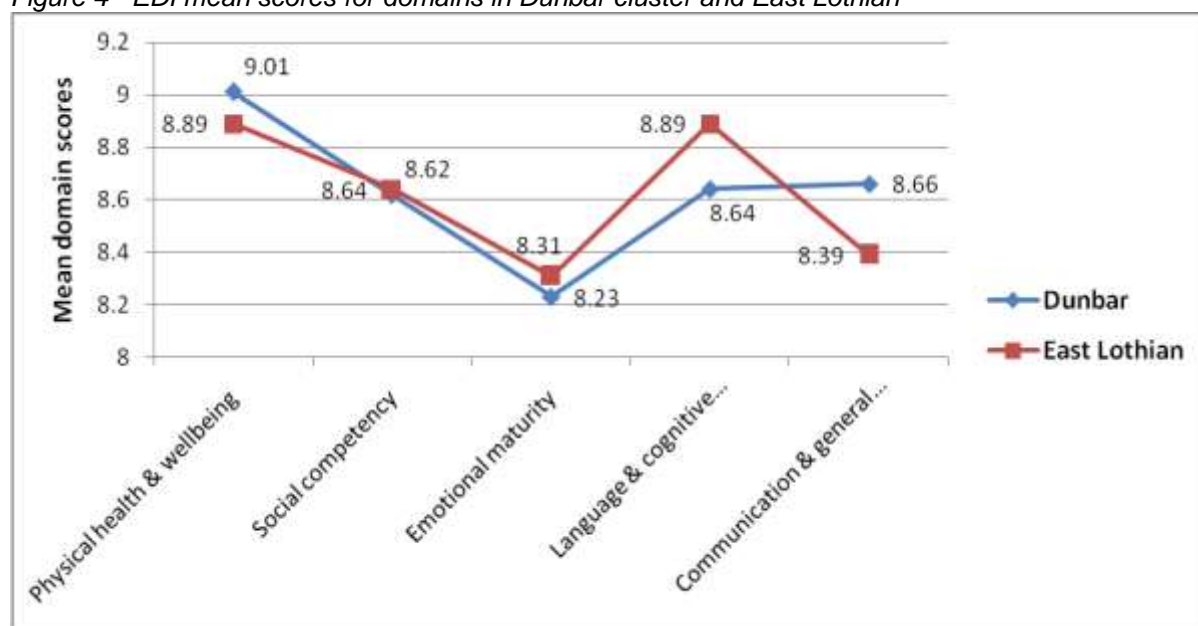

## Children & Young People

Given its population the Dunbar area has significantly lower than average levels of looked after pupils (none at home and 6 away from home), pupils with ASN and disabled pupils. The percentage of children registered for free school meals is proportionate with the overall population figures (table 2).

Table 2 - Children and Young People - Facts & Figures <sup>6</sup>

	Dunbar	East Lothian	%
Number of Pupils *	1846	13,301	14%
Looked After Pupils (at home) *	0	36	0%
Looked After Pupils (away from home) *	6	125	5%
Pupils with ASN *	176	2,368	7%
Disabled Pupils *	9	197	5%
Free School Meal Registration *	182	1,496	12%
Children & Families Social Work Referrals (2010 - 2011) **	-	-	-
Children on Child Protection Register (April 2011) **	-	-	-
Children under 5 in Foster Care (Nov 2011) **	-	-	-

\* From Primary and Secondary School Pupil Census 2011 \*\* From ELC Children & Families Social work Department

<sup>5</sup> Geddes, R (2012) Early Development Instrument report – East Lothian Pilot 2012. Scottish Collaboration for Public Health Research and Policy, Edinburgh

<sup>6</sup> East Lothian Council Education Department

## **Amenities**

The Dunbar area has a range of services and resources available to its residents which are highlighted on the map in Appendix 3

There is also considerable wider amenity and green space available in and around Dunbar (see Appendix 4). Green spaces are the lungs of towns and cities and can contribute greatly to improving people's physical and mental health by providing places for informal recreation - walking, cycling, sitting, socialising and children's play - and breathing spaces to take time out from the stresses of modern life. They bring the countryside into residential areas and local communities and make it more accessible. Green space is any vegetated land or water within or adjoining an urban area and includes:

- green corridors like paths, disused railway lines, rivers and canals
- woods, grassed areas, parks, gardens, playing fields, children's play areas, cemeteries and allotments
- countryside immediately adjoining a town which people can access from their homes
- derelict, vacant and contaminated land which has the potential to be transformed

## **Summary**

Dunbar Cluster covers the communities of Dunbar, East Linton, West Barnes, Stenton and Innerwick. This short profile indicates that population health and wellbeing is generally good and indeed better than East Lothian generally.

Educationally young people in Dunbar are well served although there remain challenges in making sure all children get the best out of education. ). Dunbar has an almost identical pattern of scores to East Lothian as a whole in all domains of the EDI and has a middle ranked percentage of children in scoring low on at least one domain

The area is generally well served for amenities and green space although there may be access issues for many of the smaller communities outwith Dunbar.



## Appendix 1 - EDI mean scores for domains in cluster areas across East Lothian

### PRESTONPANS

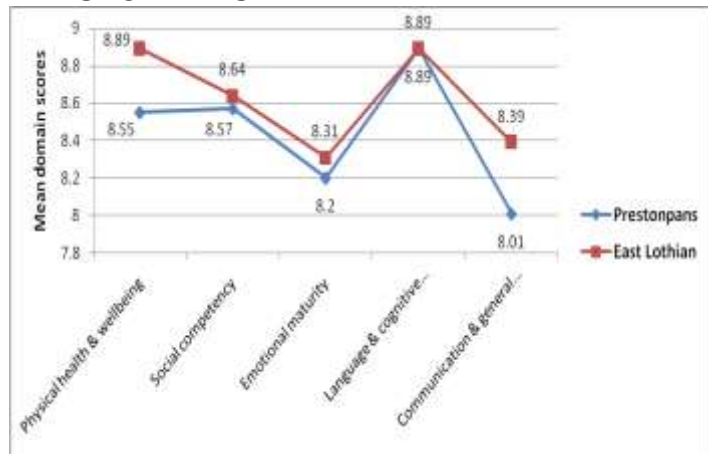

### HADDINGTON

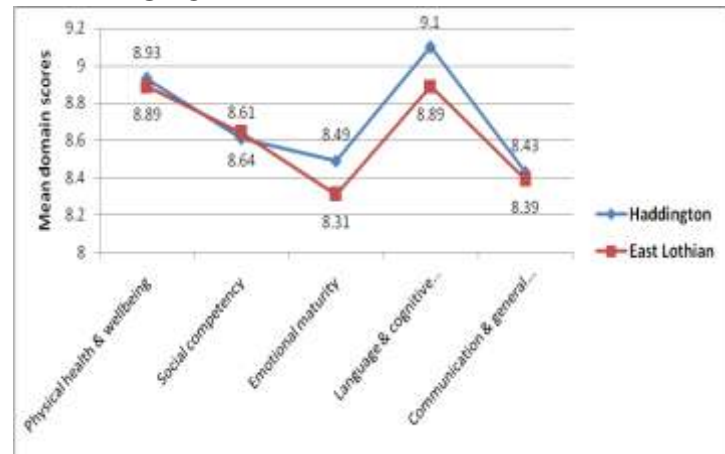

### TRANENT

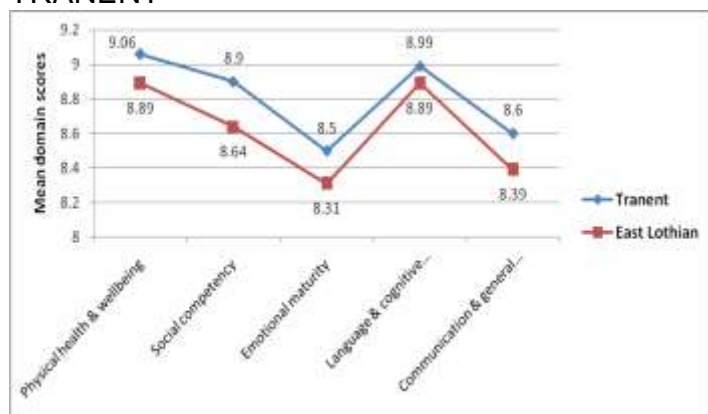

### MUSSELBURGH

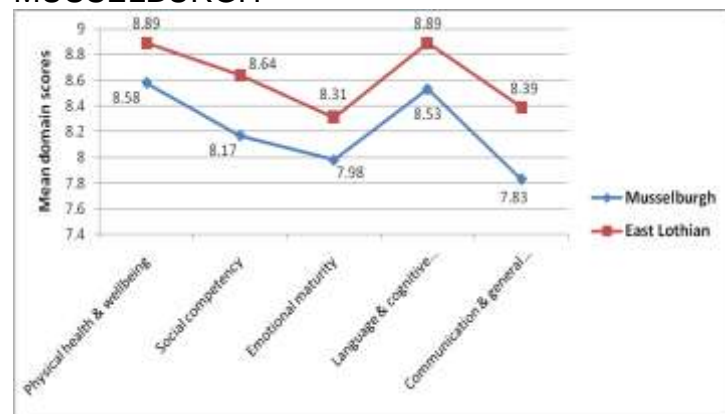

### DUNBAR

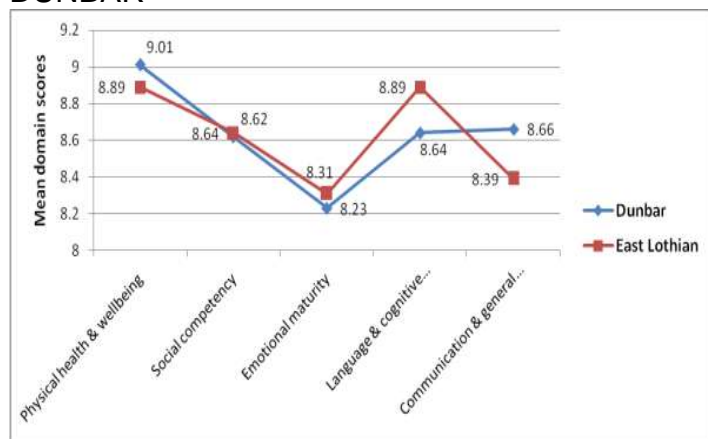

### NORTH BERWICK

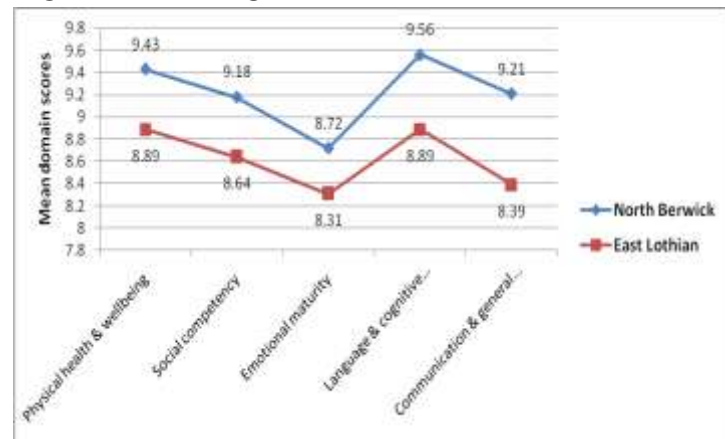

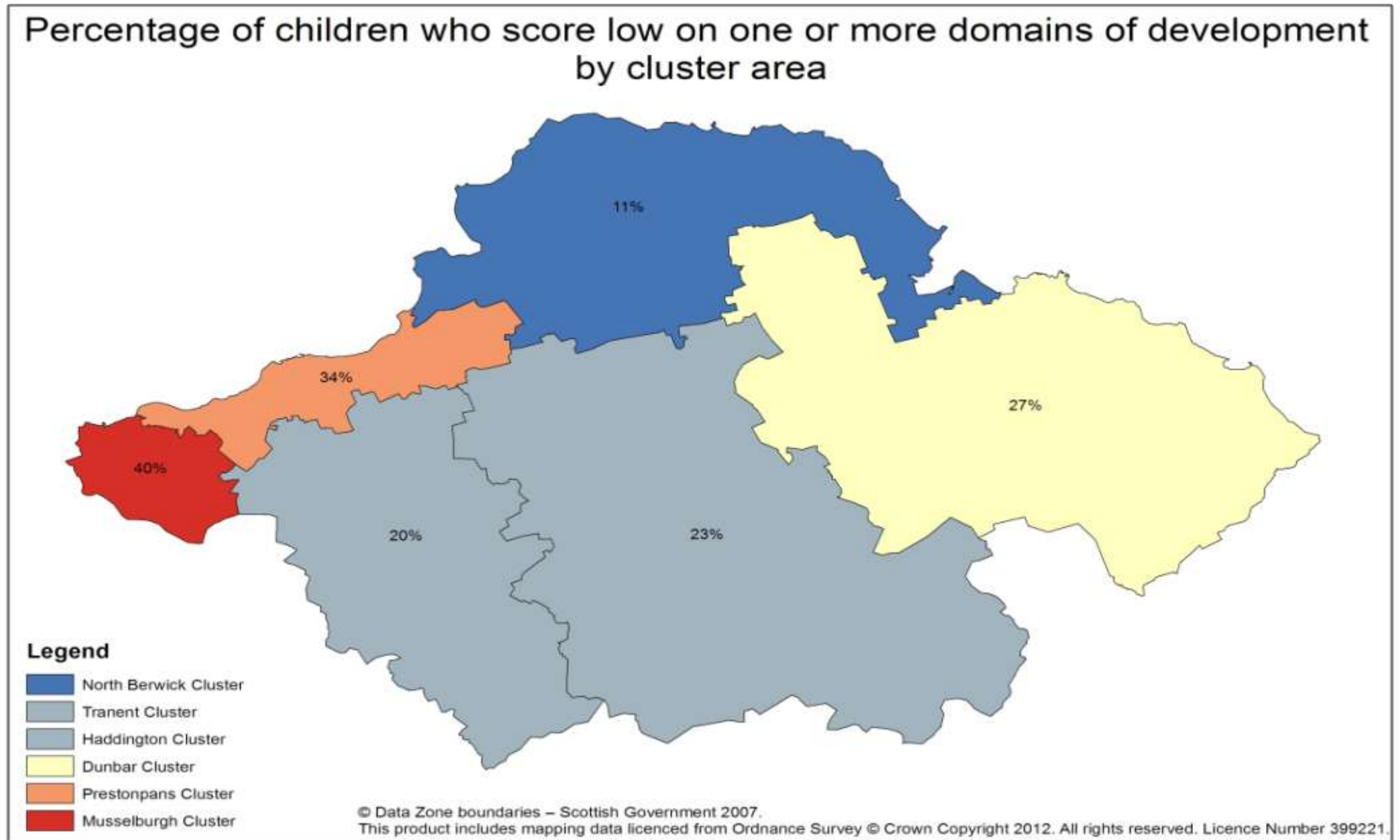



### Appendix 3 – Amenities and service in the Dunbar Cluster Area <sup>7</sup>

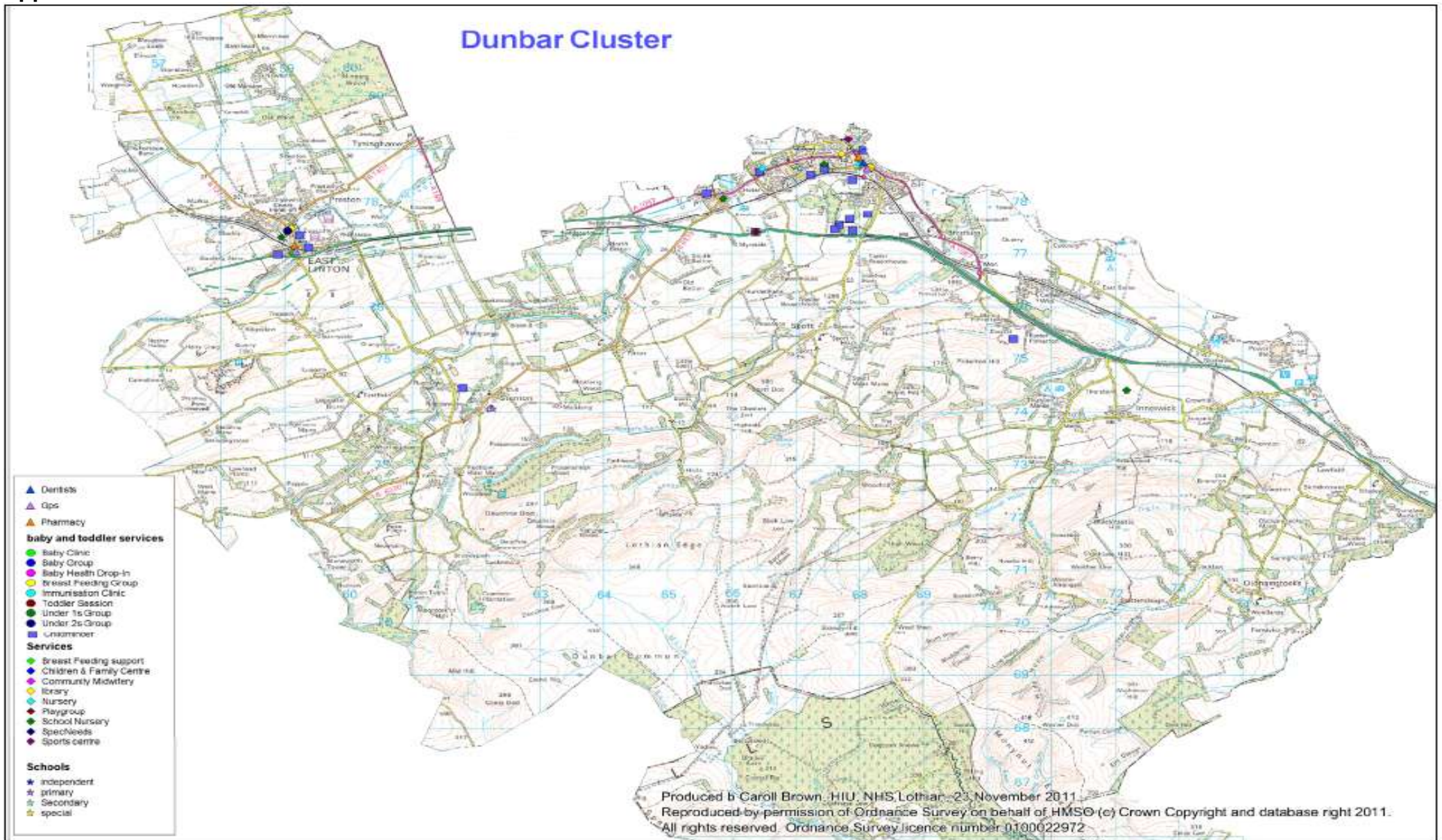

### Appendix 4 – Green network map for the Dunbar Cluster Area <sup>8</sup>

<sup>7</sup> All schools have access to educational psychology and school nursing services

<sup>8</sup> This map was taken from the Open Space Strategy Consultation pages East Lothian Council's website ([http://www.eastlothian.gov.uk/downloads/file/5143/strategic\\_green\\_network-tranent\\_cluster](http://www.eastlothian.gov.uk/downloads/file/5143/strategic_green_network-tranent_cluster))



**Legend**

-  Cluster Areas
  -  Core Paths 2010
- Greenspace Primary Land Use Codes**
-  6.1 - Public park and garden
  -  6.4 - Playspace
  -  6.51 - Playing fields
  -  6.52 - Golf courses
  -  6.61 - Green access routes
  -  6.62 - Riparian routes
  -  6.71 - Woodland
  -  6.72 - Open semi-natural
  -  6.73 - Open water
  -  6.82 - Churchyard
  -  6.83 - Cemetery
  -  6.9 - Civic space
  -  Strategic Open Space Networks 300m Buffer

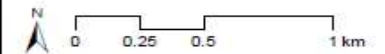
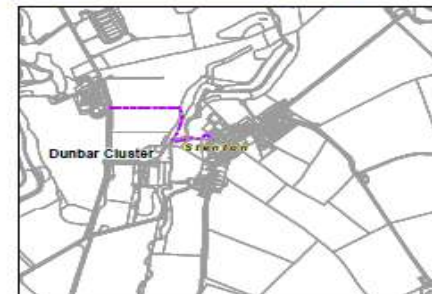
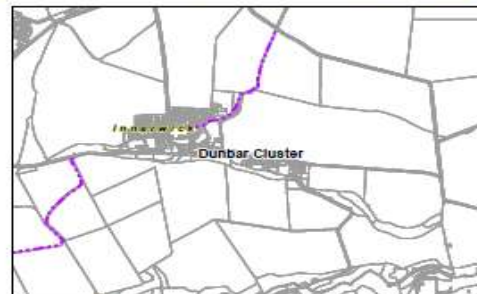
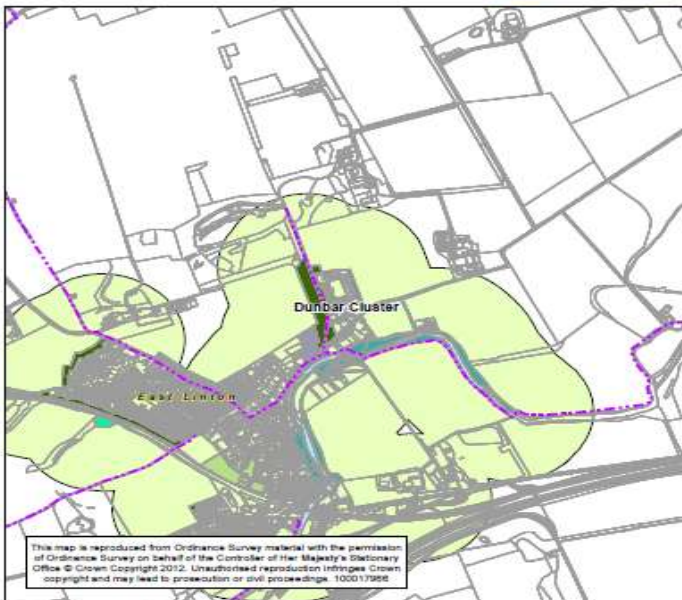
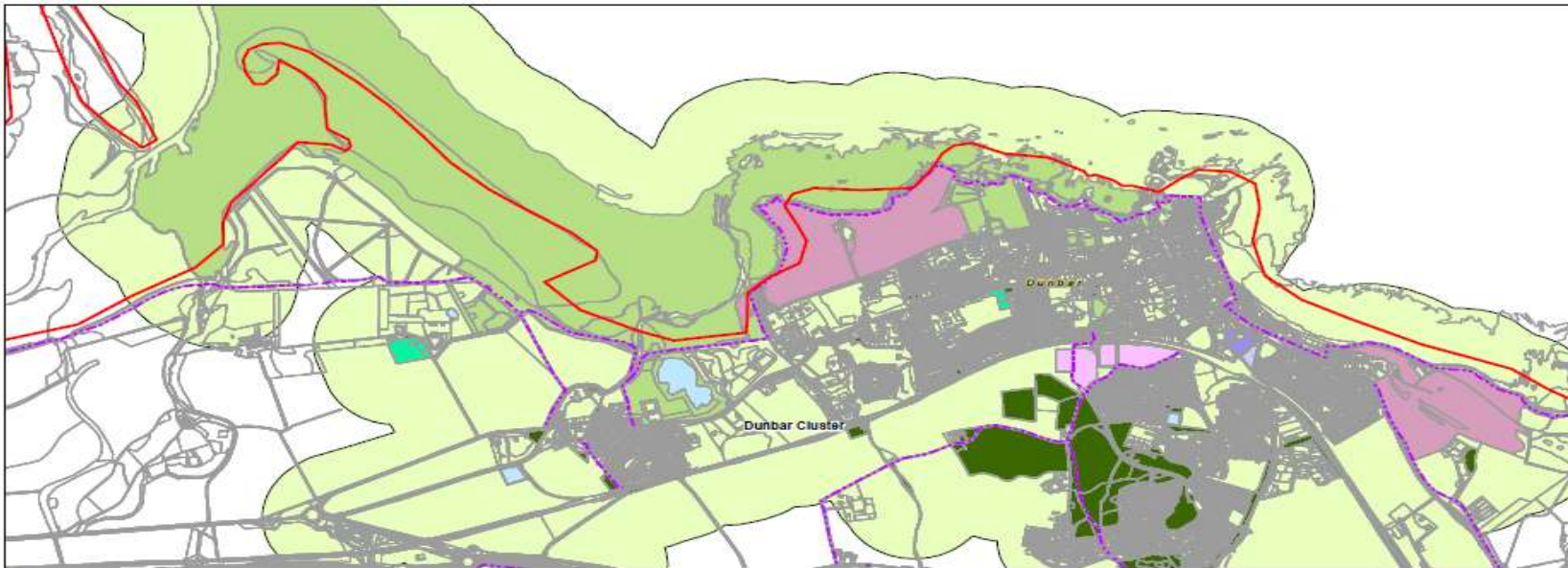

**Figure 2f**  
**Strategic  
Green Networks  
Dunbar Cluster**

